

THE KNOX

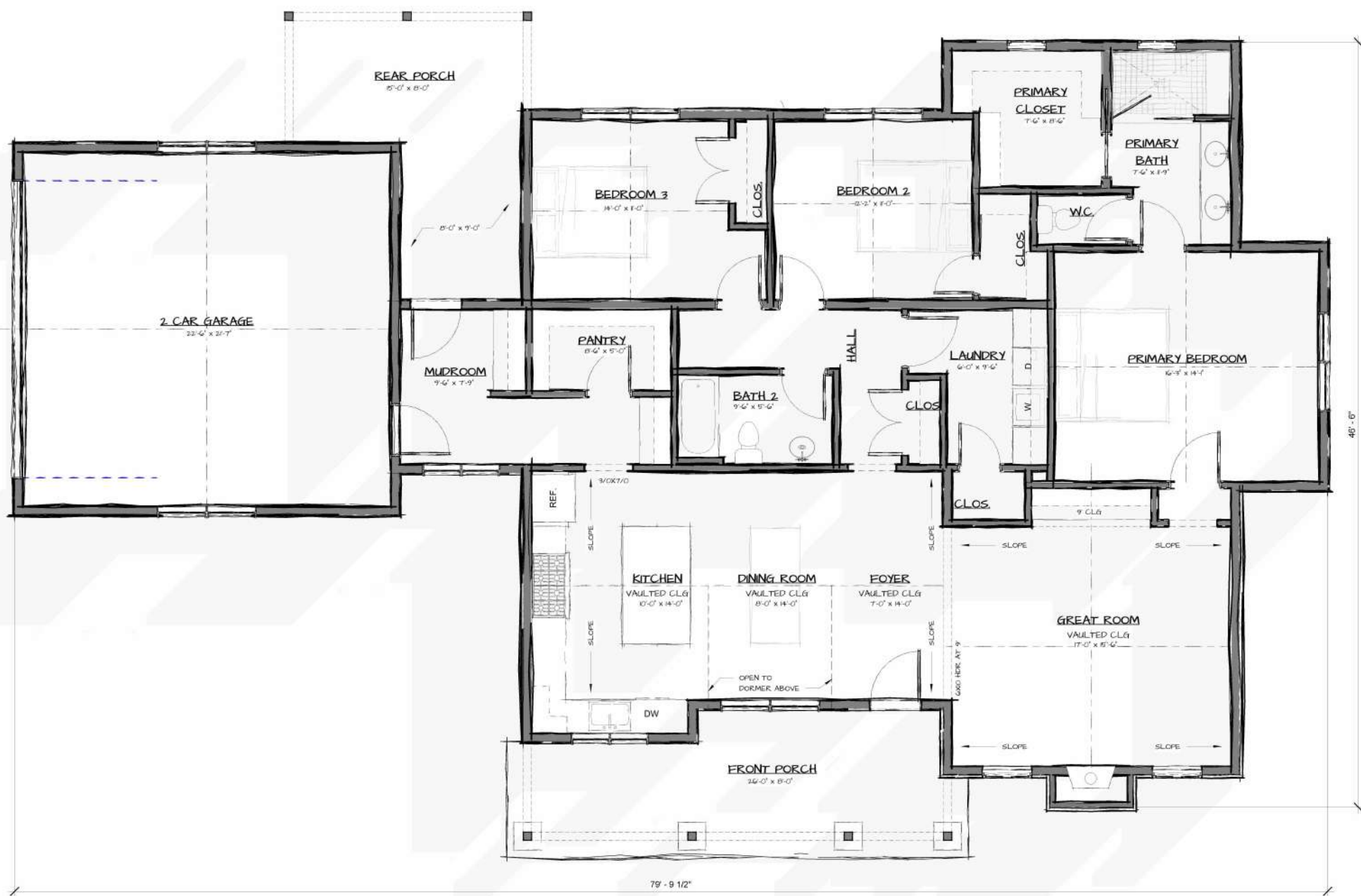

The Barndo Co.

DESIGN INFORMATION			
BEDROOMS	3	LIVING AREA	1947 S.F.
BATHROOMS	2	GARAGE	522 S.F.
GARAGES	-	PORCHES	245 S.F.
WIDTH	79'-9"	PATIO	-
DEPTH	50'-4"	TOTAL U/R	2,714 S.F.

